

# Township 7 - 13 North Range 23 - 26 East, MD&M

# BOOK 10 INDEX

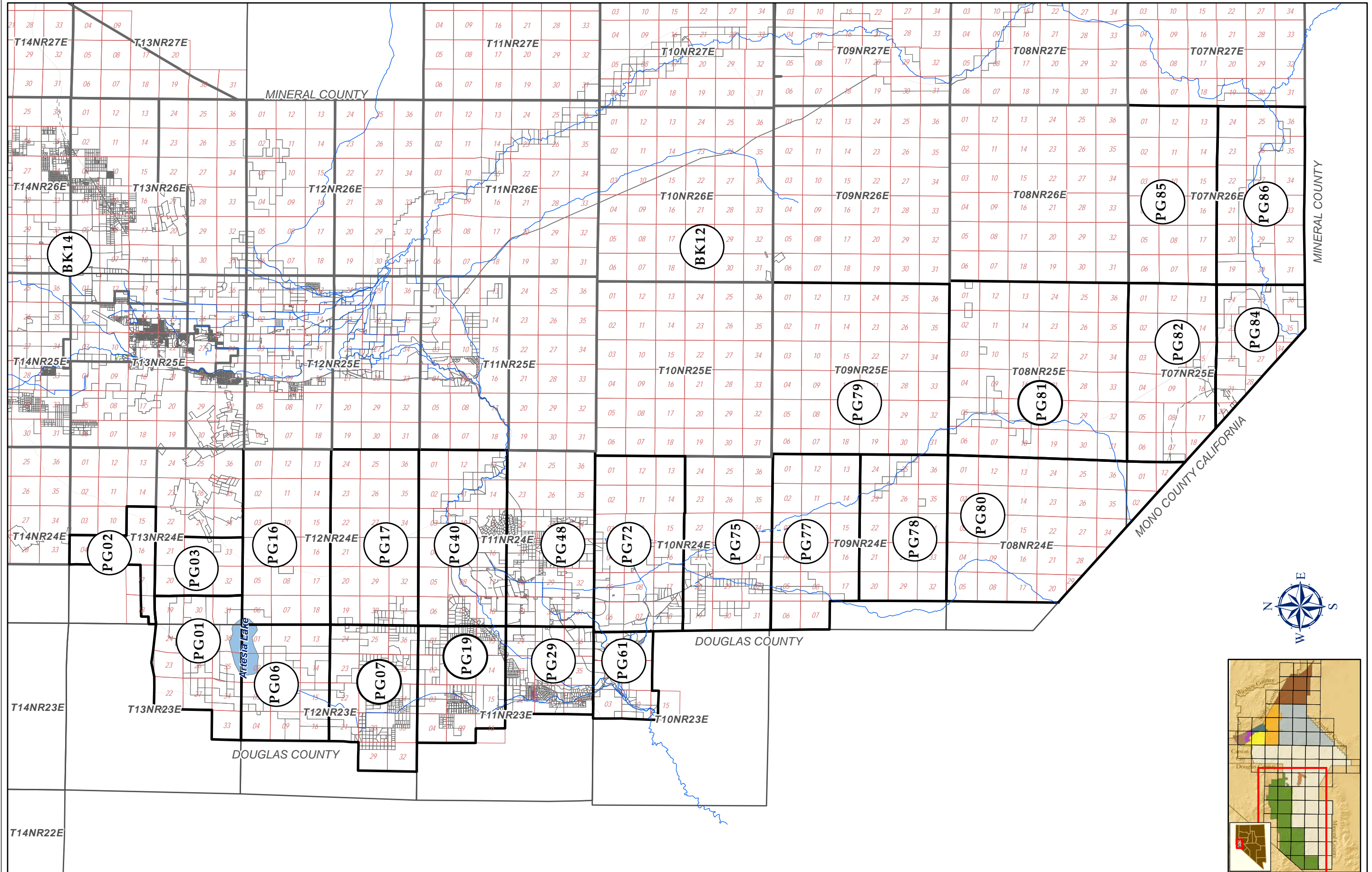

NOTE: This is for assessment use only and does not represent a survey. No liability is assumed as to the accuracy of the data delineated hereon. Use of this plat for other than assessment purposes is forbidden unless approved by the Lyon County Assessor's Office.

NO SCALE  
Revised: April 13, 2011

